

INST_80_17

H (1 : 6)

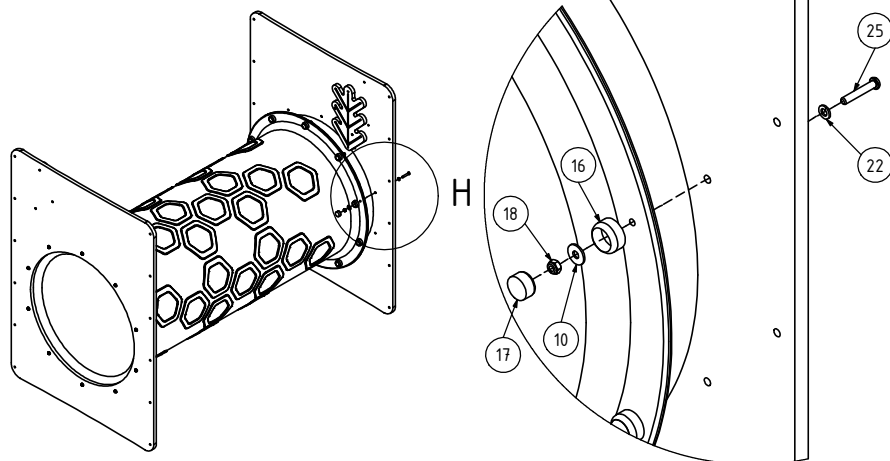

Nr:	Σ	Element:	
1	24x	S6x60	
2	24x	W6x60	
10	20x	DIN 9021 - 6x18	
16	20x	K1_d21_B	
17	20x	Z1_d21_B	
18	20x	DIN 985 - M6	
22	20x	DIN 125 - 6x12	
25	20x	ISO 7380 - M6x35	

2

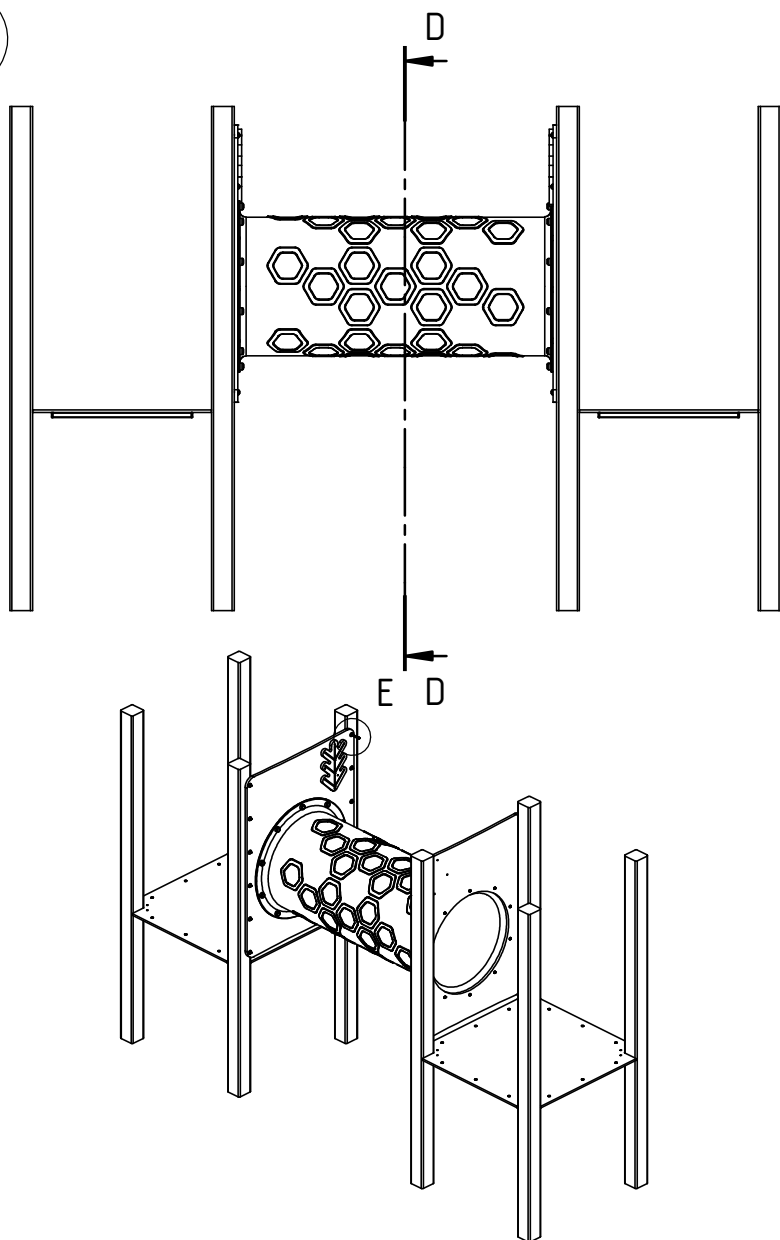

D-D (1 : 30)

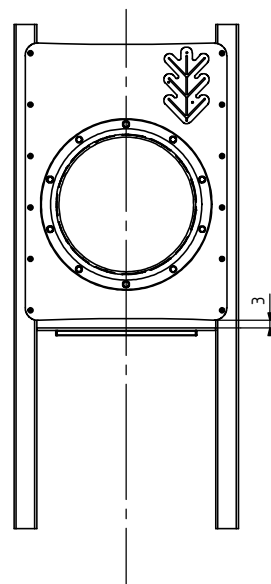

E (1 : 3)

